

# GOODMAN SHATIN LOGISTICS CENTRE + Goodman

嘉民沙田物流中心



## FULLY EQUIPPED AND ACCESSIBLE WAREHOUSE 配套完善 交通便捷

### KEY PROPERTY FEATURES:

- + Warehouse building with flexible floor plates  
每層倉庫可靈活分間單位
- + 11 cargo lifts and two passenger lifts  
設11部載貨升降機及2部客用升降機
- + Functional loading and unloading spaces over two floors  
備有貨物起卸台於兩樓層, 供貨車及貨櫃車使用
- + Close proximity to Fo Tan station and great connectivity to major business districts via Tolo Highway  
鄰近港鐵火炭站, 經吐露港公路直達各主要商業區

**308,900** SQ FT  
總面積

6 WONG CHUK YEUNG  
STREET, FOTAN, SHATIN  
沙田火炭黃竹洋街6號



**1.5KM**

to Fo Tan MTR  
至火炭港鐵站



**13.0KM**

to Container Terminal  
至貨櫃碼頭



**43.2KM**

to HK Int'l Airport  
至香港國際機場



**26.5KM**

to Man Kam To  
至文錦渡

LEASING ENQUIRY+  
租務查詢+

Lisa Li  
lisa.li@goodman.com  
T 852 2249 3136

Taylor Tam  
taylor.tam@goodman.com  
T 852 2249 3123

hk.goodman.com



+852 6111 9353

# PLANS +

## 規劃

### SITE PLAN 平面圖

### GOODMAN SHATIN LOGISTICS CENTRE 嘉民沙田物流中心

#### DETAILS 倉庫資料

Floor plate (sq ft) 每層樓面面積 (平方呎)	4,100-15,510
Ceiling height (ft / m) 樓底高度 (呎 / 米)	14-15 / 4.46-4.64
Floor loading capacity (lbs / sq ft) 樓面負重量 (磅 / 平方呎)	300
No. of cargo lifts 載貨升降機	11
Cargo lift loading capacity (kg) 載貨升降機負重量 (公斤)	2,500-5,000

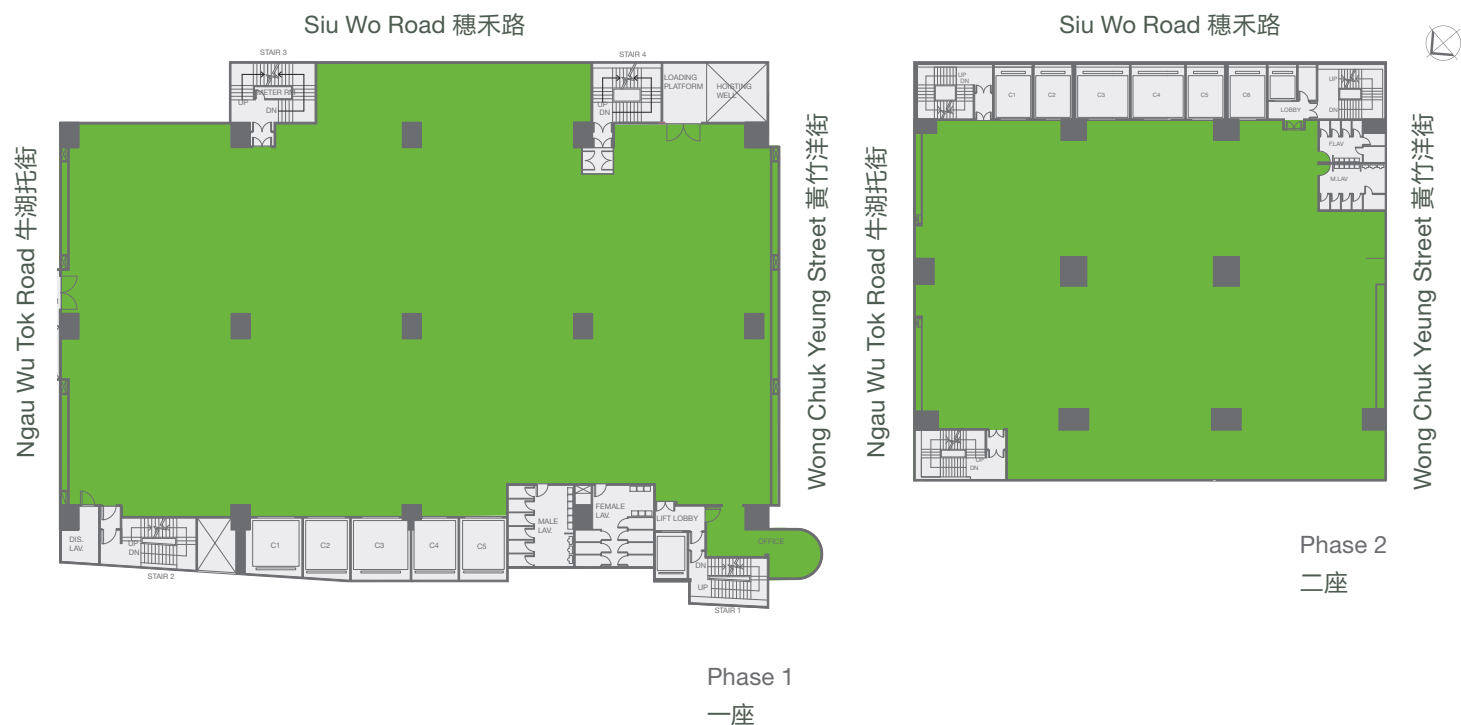

#### Disclaimer 免責聲明:

This document has been prepared by Goodman Asia Limited for general information purposes only. Whilst every care has been taken in relation to its accuracy, no warranty of accuracy is given or implied. Interested parties should obtain independent advice before making any decisions about the property referred to in this document. Images contained in this document have been used to enable the visualisation of the building concepts only. 本文件由Goodman Asia Limited ("Goodman") 製作, 內容僅供作一般參考之用。Goodman已竭力確保文件所提供之資料準確, 但對於資料之準確度, Goodman並不作任何承諾或保證。對本文件所提及之物業有興趣之人士, 須自行尋求獨立專業人士提供意見。而本文件所刊載之圖片, 只供作瞭解物業概念之用。