

GOODMAN KWAI CHUNG LOGISTICS CENTRE +

Goodman

嘉民葵涌物流中心



AFFORDABLE WAREHOUSE FACILITY IN PREMIUM LOCATION

優越地段 實用空間

KEY PROPERTY FEATURES:

- + Sub-divisible floor plates
每層可靈活分間單位
- + Functional loading and unloading spaces over two levels
設有貨物起卸台於兩樓層供貨車使用
- + Six cargo lifts and two passenger lifts
共6部載貨升降機及2部客用升降機
- + Close to Tai Wo Hau station
鄰近港鐵大窩口站

397,100 SQ FT
總面積

585-609 CASTLE PEAK ROAD
KWAI CHUNG
葵涌青山公路585-609號



2.2KM

to Tai Wo Hau MTR
至大窩口港鐵站



7.7KM

to Container Terminal
至貨櫃碼頭



33.3KM

to HK Int'l Airport
至香港國際機場



33.3KM

to Man Kam To
至文錦渡

LEASING ENQUIRY 租務查詢

Lisa Li
lisa.li@goodman.com
T 852 2249 3136

Taylor Tam
taylor.tam@goodman.com
T 852 2249 3123

goodman.com/hk



PLANS+

規劃

SITE PLAN 平面圖

GOODMAN KWAI CHUNG LOGISTICS CENTRE 嘉民葵涌物流中心

DETAILS 倉庫資料

Floor plate (sq ft)
每層樓面面積 (平方呎) 25,469–26,050

Ceiling height (ft / m)
樓底高度 (呎 / 米) 11–12 / 3.35–3.65

Floor loading capacity (lbs / sq ft)
樓面負重量 (磅 / 平方呎) 150–250

No. of cargo lifts
載貨升降機 6

Cargo lift loading capacity (kg)
載貨升降機負重量 (公斤) 2,050

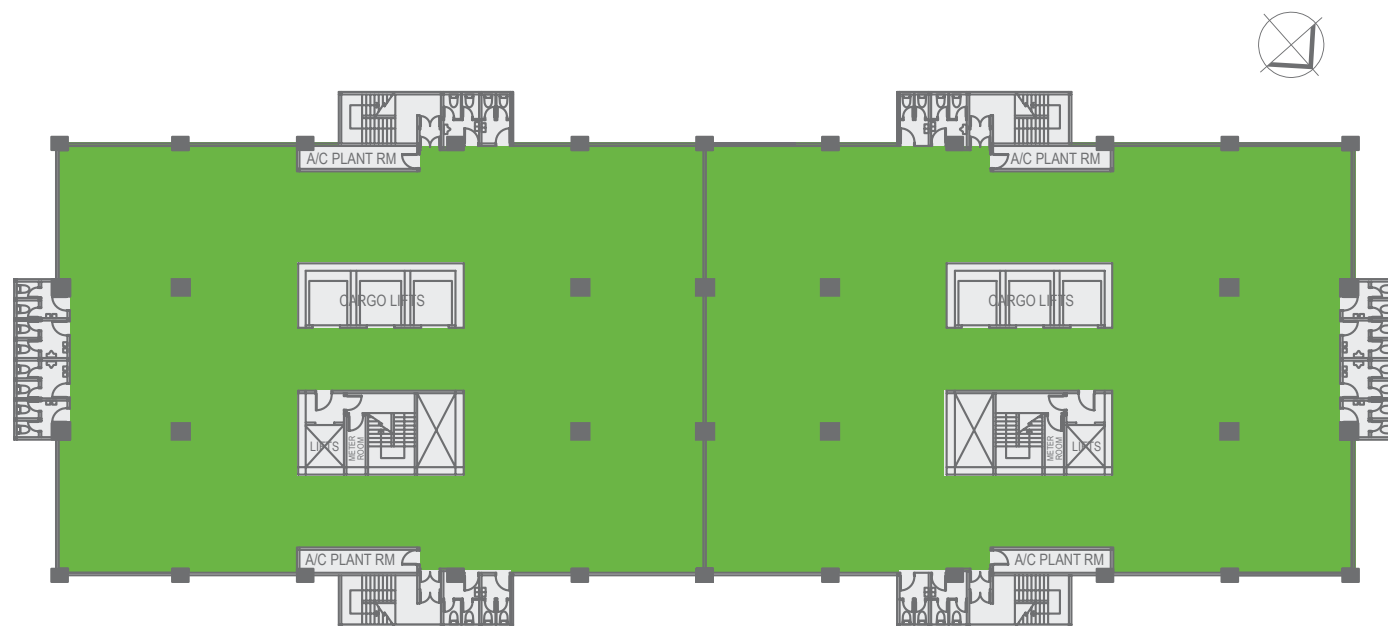
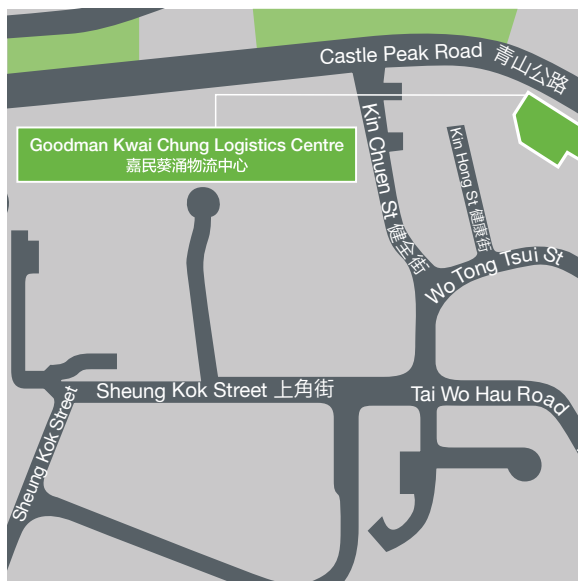

Castle Peak Road 青山公路

Disclaimer 免責聲明:

This document has been prepared by Goodman Asia Limited for general information purposes only. Whilst every care has been taken in relation to its accuracy, no warranty of accuracy is given or implied. Interested parties should obtain independent advice before making any decisions about the property referred to in this document. Images contained in this document have been used to enable the visualisation of the building concepts only. 本文件由Goodman Asia Limited ("Goodman") 製作, 內容僅供作一般參考之用。Goodman已竭力確保文件所提供之資料準確, 但對於資料之準確度, Goodman並不作任何承諾或保證。對本文件所提及之物業有興趣之人士, 須自行尋求獨立專業人士提供意見。而本文件所刊載之圖片, 只供作瞭解物業概念之用。