

# GOODMAN WESTERN PLAZA +

Goodman

嘉民環宇物流廣場



## FUNCTIONAL FLOOR PLATE FOR LOGISTIC OPERATIONS 實用樓面 設施完善

### KEY PROPERTY FEATURES:

- + Flexible and functional floor plates  
每層樓面面積靈活實用
- + Functional loading and unloading spaces  
設有貨物起卸台供貨櫃車使用
- + Equipped with security and fire alarm systems linked to control centre  
保安消防系統連接控制中心
- + Close to Tuen Mun MTR station  
鄰近港鐵屯門站

**1,304,100** SQ FT 總面積

3 SAN ON STREET  
TUEN MUN  
屯門新安街3號



**1.0KM**

to Tuen Mun MTR  
至屯門港鐵站



**21.3KM**

to Lok Ma Chau  
至落馬洲



**25.9KM**

to Container Terminal  
至貨櫃碼頭



**15.9KM**

to HK Int'l Airport  
至香港國際機場

## LEASING ENQUIRY 租務查詢

Lisa Li  
lisa.li@goodman.com  
T 852 2249 3136

Taylor Tam  
taylor.tam@goodman.com  
T 852 2249 3123

goodman.com/hk



# PLANS+

## 規劃

### SITE PLAN 平面圖

#### GOODMAN WESTERN PLAZA 嘉民環宇物流廣場

##### DETAILS 倉庫資料

Floor plate (sq ft) 每層樓面面積 (平方呎)	53,000–79,400
Ceiling height (ft / m) 樓底高度 (呎 / 米)	10–17 / 3.06–5.29
Floor loading capacity (lbs / sq ft) 樓面負重量 (磅 / 平方呎)	150–500
No. of cargo lifts 載貨升降機	14
Cargo lift loading capacity (kg) 載貨升降機負重量 (公斤)	2,000–4,500

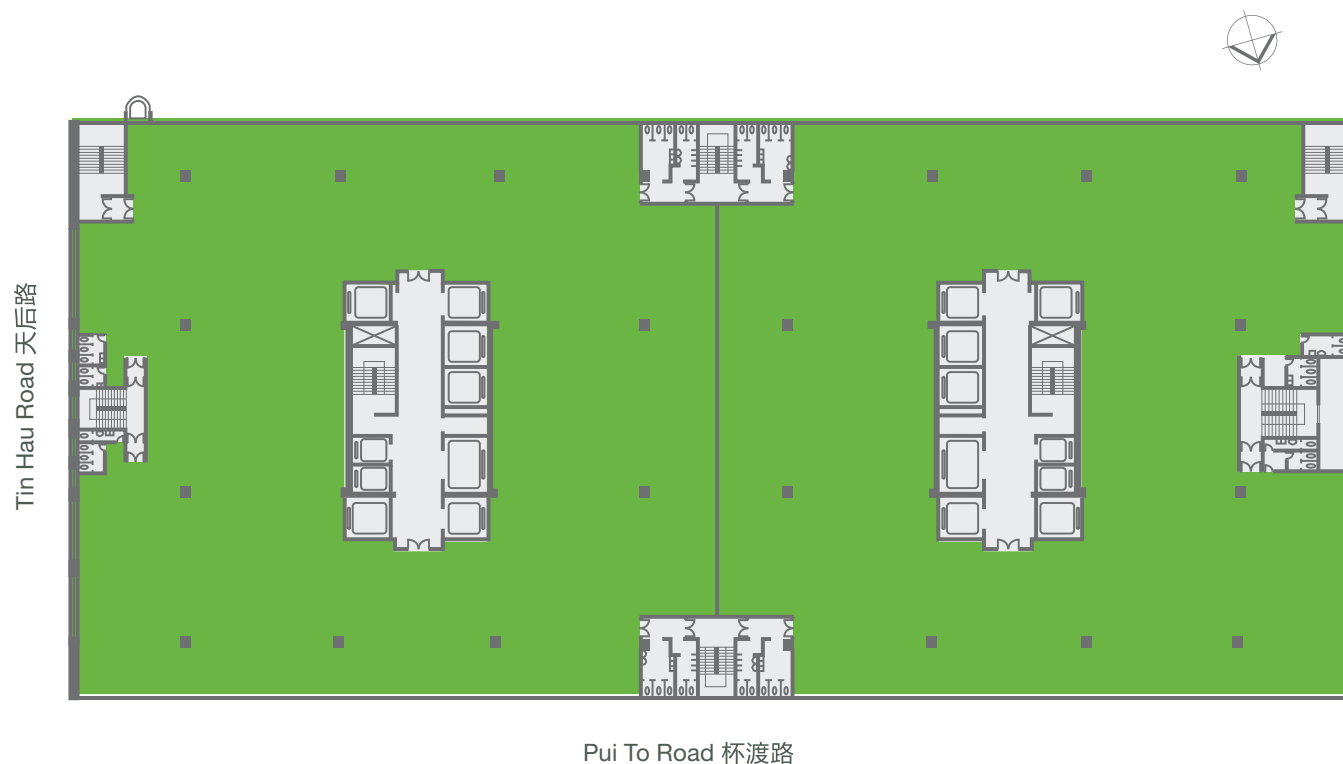
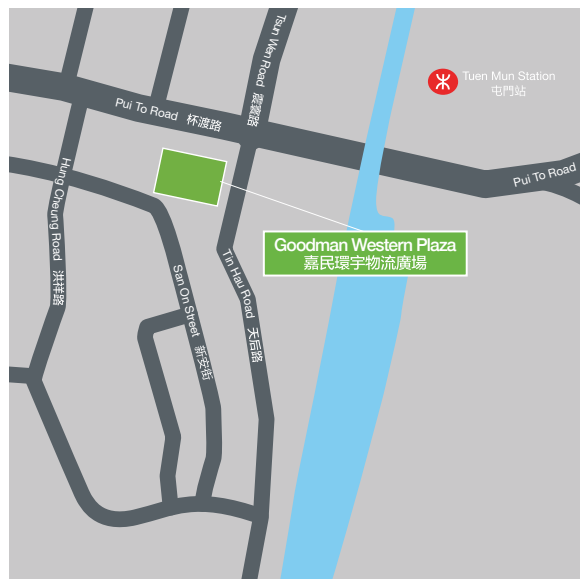

##### Disclaimer 免責聲明:

This document has been prepared by Goodman Asia Limited for general information purposes only. Whilst every care has been taken in relation to its accuracy, no warranty of accuracy is given or implied. Interested parties should obtain independent advice before making any decisions about the property referred to in this document. Images contained in this document have been used to enable the visualisation of the building concepts only. 本文件由Goodman Asia Limited ("Goodman") 製作，內容僅供作一般參考之用。Goodman已竭力確保文件所提供之資料準確，但對於資料之準確度，Goodman並不作任何承諾或保證。對本文件所提及之物業有興趣之人士，須自行尋求獨立專業人士提供意見。而本文件所刊載之圖片，只供作瞭解物業概念之用。