

# GOODMAN YUEN LONG LOGISTICS CENTRE+

Goodman

嘉民元朗物流中心



## GREAT CHOICE FOR LOGISTICS BUSINESS

優質倉庫 物流首選

### KEY PROPERTY FEATURES:

- + Ample loading and unloading bays  
設有充足貨物起卸台供貨車及貨櫃車使用
- + Experienced on-site management services  
提供經驗豐富專業保安管理服務
- + Great connectivity via New Territories Circular Road and Yuen Long Highway  
經新界環迴公路及元朗公路連接各區

**322,400** SQ FT  
總面積

19 TAK YIP STREET  
YUEN LONG  
元朗德業街19號



**0.9KM**

to Yuen Long MTR  
至元朗港鐵站



**11.3KM**

to Lok Ma Chau  
至落馬洲



**23.9KM**

to Container Terminal  
至貨櫃碼頭



**24KM**

to HK Int'l Airport  
至香港國際機場

## LEASING ENQUIRY 租務查詢

**Lisa Li**  
lisa.li@goodman.com  
T 852 2249 3136

**Taylor Tam**  
taylor.tam@goodman.com  
T 852 2249 3123

goodman.com/hk



# PLANS+

## 規劃

### SITE PLAN 平面圖

#### GOODMAN YUEN LONG LOGISTICS CENTRE 嘉民元朗物流中心

##### DETAILS 倉庫資料

Floor plate (sq ft)  
每層樓面面積 (平方呎) 18,215-34,117

Ceiling height (ft / m)  
樓底高度 (呎 / 米) 15-17 / 4.57-5.18

Floor loading capacity (lbs / sq ft)  
樓面負重量 (磅 / 平方呎) 250-300

No. of cargo lifts  
載貨升降機 7

Cargo lift loading capacity (kg)  
載貨升降機負重量 (公斤) 3,000-5,000

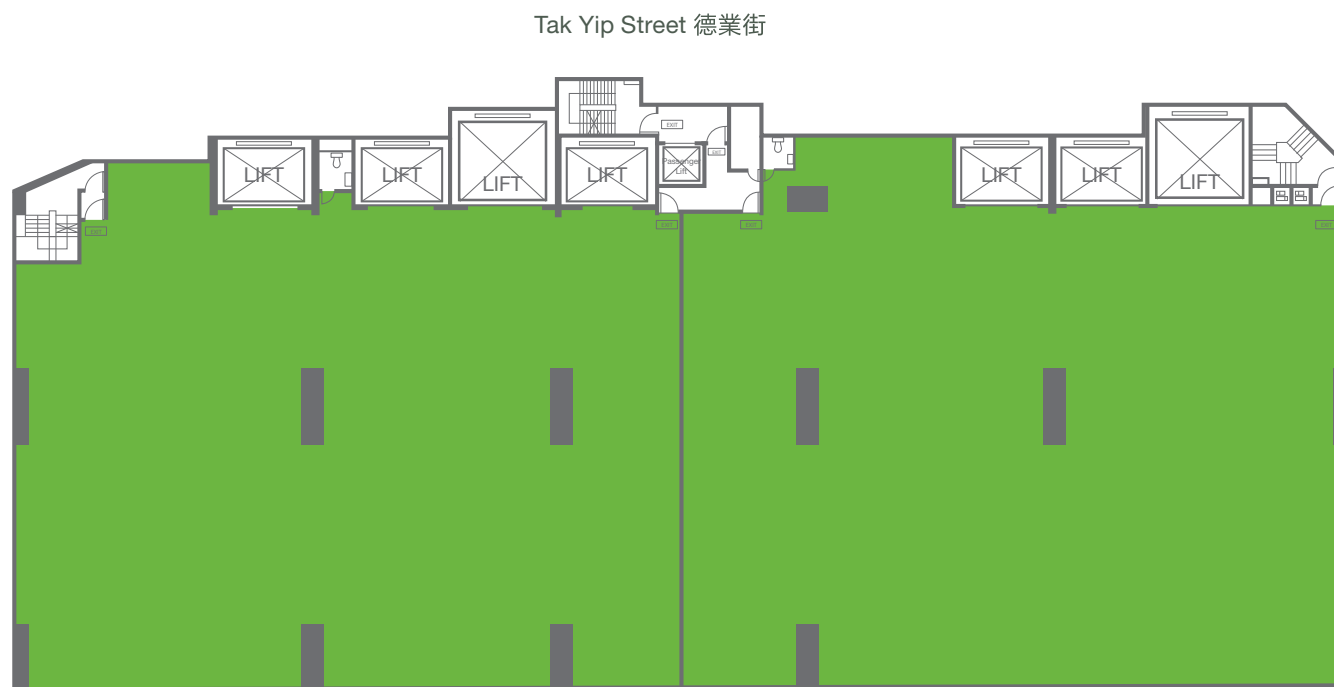
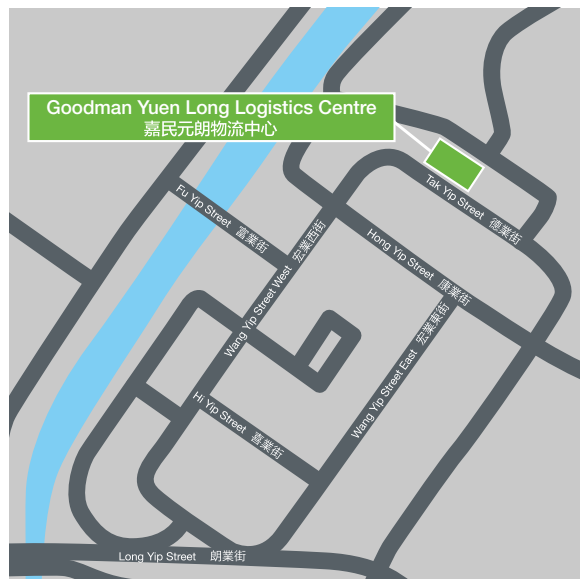

##### Disclaimer 免責聲明:

This document has been prepared by Goodman Asia Limited for general information purposes only. Whilst every care has been taken in relation to its accuracy, no warranty of accuracy is given or implied. Interested parties should obtain independent advice before making any decisions about the property referred to in this document. Images contained in this document have been used to enable the visualisation of the building concepts only. 本文件由Goodman Asia Limited ("Goodman") 製作, 內容僅供作一般參考之用。Goodman已竭力確保文件所提供之資料準確, 但對於資料之準確度, Goodman並不作任何承諾或保證。對本文件所提及之物業有興趣之人士, 須自行尋求獨立專業人士提供意見。而本文件所刊載之圖片, 只供作瞭解物業概念之用。