



# GOODMAN YUEN LONG LOGISTICS CENTRE

## 嘉民元朗物流中心

Great choice for logistics business  
優質倉庫 物流首選

### KEY PROPERTY FEATURES:

Ample loading and unloading bays  
設有充足貨物起卸台供貨車及貨櫃車使用

Experienced on-site management services  
提供經驗豐富專業保安管理服務

Great connectivity via New Territories Circular Road and Yuen Long Highway  
經新界環迴公路及元朗公路連接各區



**12MIN**

walk to Yuen Long MTR  
步行至元朗港鐵站



**23MIN**

drive to Container Terminal  
行車至貨櫃碼頭



**16MIN**

drive to Lok Ma Chau  
行車至落馬洲



**29MIN**

drive to HK International Airport  
行車至香港國際機場



MAKING SPACE FOR GREATNESS

**YUEN LONG 元朗**  
19 TAK YIP STREET  
德業街19號

# PLANS

## 規劃

# 322,400 SQ FT

平方呎

Total Gross Area (sq ft)  
總建築面積 (平方呎)

Floor plate (sq ft)  
每層樓面面積 (平方呎)

18,215-34,117

Ceiling height (ft/m)  
樓高 (呎/米)

15-17 / 4.57-5.18

Floor loading capacity (lbs/sq ft)  
樓面負重量 (磅 / 平方呎)

250-300

No. of cargo lifts  
載貨升降機

7

Cargo lift loading capacity (kg)  
載貨升降機負重量 (公斤)

3,000-5,000

Typical floor plan  
平面圖

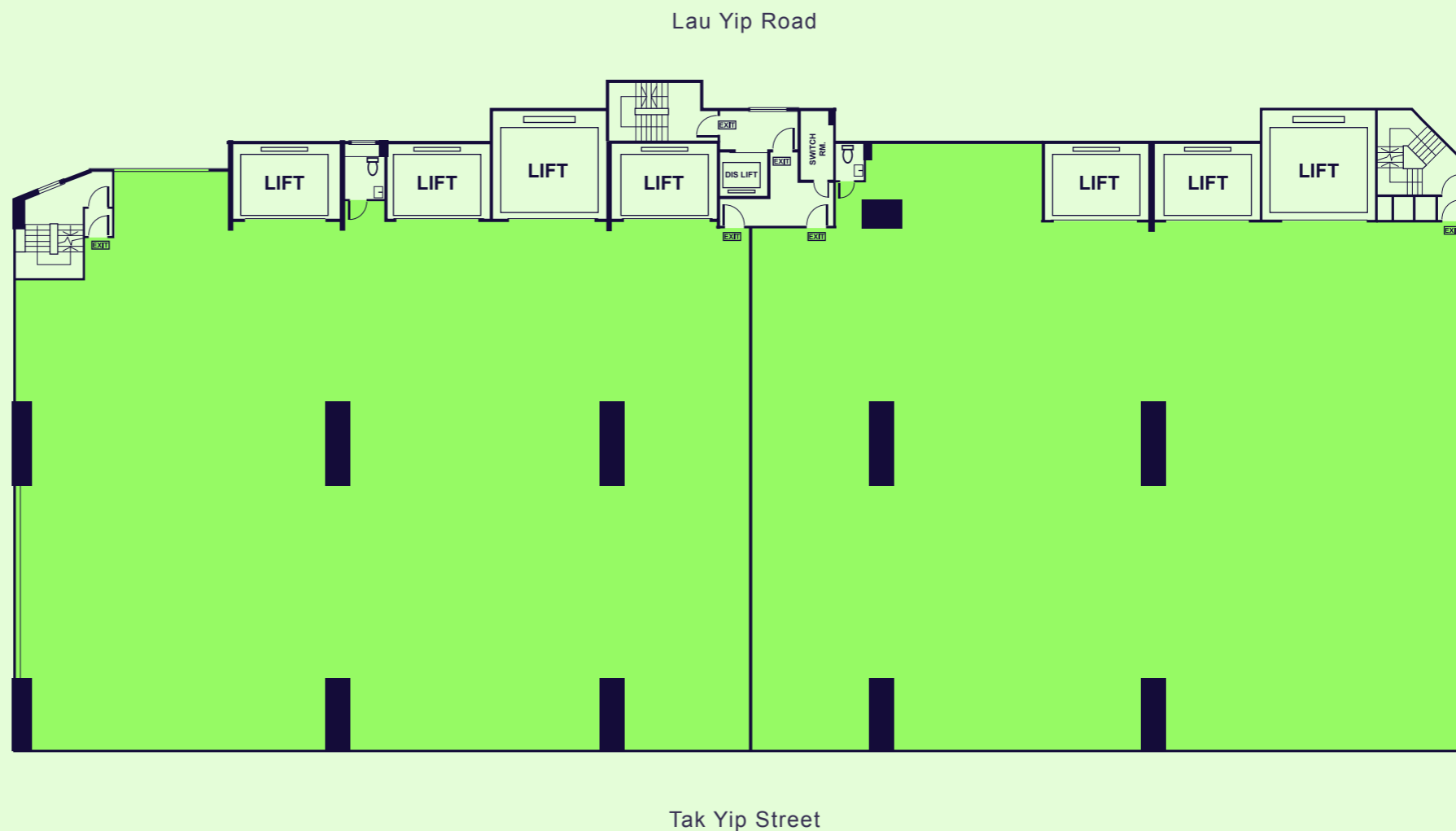

### Disclaimer 免責聲明:

This document has been prepared by Goodman Asia Limited for general information purposes only. Whilst every care has been taken in relation to its accuracy, no warranty of accuracy is given or implied. Interested parties should obtain independent advice before making any decisions about the property referred to in this document. Images contained in this document have been used to enable the visualisation of the building concepts only.

本文件由Goodman Asia Limited ("Goodman")製作，內容僅供作一般參考之用。Goodman已竭力確保文件所提供之資料準確，但對於資料之準確度，Goodman並不作任何承諾或保證。對本文件所提及之物業有興趣之人士，須自行尋求獨立專業人士提供意見。而本文件所刊載之圖片，只供作瞭解物業概念之用。

Leasing hotline  
租務熱線

2249 3188  
leasing.hk@goodman.com

goodman.com/hk

